



BUSBI



HORNET

USE OF ELECTRIC SCOOTERS

LEGAL WARNING:

- United Kingdom law – This e-scooter is not to be used on public roads, cycle paths or pavements.
- Only to be used on private land and with the landowner's permission.

IMPORTANT!

Read these instructions carefully and keep for future reference

Do not use the e-scooter when under the influence of medication or alcohol.

The user should check the limits of use in accordance with the local regulations (e.g. use in pedestrian areas, on-road).

Watch for pedestrians and others in your vicinity when riding.

Always wear a helmet and suitable footwear when riding this e-scooter.

Ensure your battery is fully charged before use.

This product is not a toy, and is intended for riders aged 16+ years.

PLEV Class 2 - Designed to carry a single rider.

Do not use this e-scooter in rain, snow or icy conditions.

Read this manual and all warning labels on the product before using this product.



Additional Information

For more guidance and support videos to help you get started, please visit: busbistore.com/videos or, simply open the camera app on your mobile phone, and point the camera at the QR code below:



Warnings

The following symbols and words are used in this user manual to signal and warn against **personal injury** or damage to property. Warnings are intended to draw attention to potential dangers.

Failure to follow a warning, may result in injury to yourself or other people, as well as causing damage to property. Please read and follow all warnings.



DANGER

This warning identifies a hazard with a high degree of risk, that could result in serious injury or death if not avoided.



WARNING

This warning identifies a hazard with a moderate degree of risk, that could result in serious injury if not avoided.



CAUTION

This warning identifies a hazard with a low degree of risk, that could result in minor or moderate injury if not avoided.



NOTE

This warning calls attention to potential property damage.

Table of Contents:

Section:	Page	Section:	Page
1. General Information.	1	6. General Maintenance.	18
1.1 Warranty.	1	6.1. Stem Locking Mechanism.	18
1.2 Conditions of Use.	1,2	6.2. Brake Adjustment and Maintenance.	18
2. Getting Started.	6	6.3. Adjusting the Mechanical Disc Brakes.	18
2.1 Package Contents.	6	6.4. Brake discs.	19
3. Preparing for First Use.	8	6.5. Changing the brake pads.	19
3.1 Assembly.	8	7. Cleaning and Storage.	19
3.2 Brake Cables – Fitment.	8	8. Further Guidance for safe use.	20
3.3 Folding and Unfolding the Busbi Hornet.	9	8.1. Weight limits.	21
3.4 Charging.	9	8.2. Maximum travel distance.	21
3.4.1 Connect the Charger.	9	9. Safety Features.	22
3.4.2 Charging Complete.	9	10. Busbi - Reducing Waste.	23
4. Riding your Busbi Hornet.	10	10.1 Disposal.	23
4.1. Braking.	11	Annex A	
4.2 Display Screen.	12	Table 1 Inspection Schedule.	24
4.2.1 Fault Codes.	12	Table 2 Hornet Specifications.	25
4.2.2. Unlocking the Busbi Hornet.	12	Table 3 Charger Specifications.	25
4.2.3 Pin Lock Function Activating/Deactivating.	13	Table 4 Hornet Dimensions.	25
4.2.4. Changing the Pin Lock Code.	13	Table 5 Battery specifications.	26
4.2.5. Lights – Operation.	13	Declaration of Conformity.	27
4.2.6. Speed modes.	13	Serial Number Identification.	28
5. Battery Charging.	15		
5.1. Battery Care and Safety.	15		
5.2. Using the Battery Charger.	15		
5.3. Charging Procedure.	16		
5.4. Battery.	16		
5.5. Battery Life.	16		
5.6. General Precautions.	16		
5.7. Battery service life	17		
5.8. Using the battery.	17		

READ BEFORE USE

1. General Information:

This instruction manual will provide you with the information you need to use and maintain your Busbi Hornet e-scooter.

Please read and retain these instructions for future use.

This manual contains important instructions for safety and care.

It is the responsibility of the user to read this manual and to follow these instructions before using the product.

Failure to follow these instructions exposes the rider to the risk of injury or death.

Regular checks and maintenance are necessary to prevent premature wear or damage to components which may result in an accident and or damage to your e-scooter.

1.1. Warranty.

Our Warranty does not cover normal wear and tear, damage caused by accidents, improper use, excessive loads, improper assembly or maintenance, and damage caused by modification. **For more information, please visit:** busbistore.com/warranty

1.2 Conditions of Use.

- At the time of manufacture, it is illegal to use an e-scooter on public roads, pavements, cycle lanes or bridleways in the United Kingdom.
- Before use, read this manual carefully ensuring that you have understood all information.
- This e-scooter is designated PLEV Class 2.
- This e-scooter is intended to be used by one rider at a time.
- This e-scooter is to be used by persons aged 16 years and above.
- You may use an e-scooter on private land, where the owner has given permission.
- This e-scooter is not intended for use on rough uneven ground, doing so may lead to a fall and serious injury.
- This e-scooter must be properly maintained in accordance with these instructions.
- Periodically inspect your e-scooter confirming it is in safe working order.
- If you are in any doubt over the safe working order of your e-scooter, stop using it immediately and consult a competent tradesman.
- Failure to comply with any warnings may result in injury to persons and property, and/or cause premature and potentially irreversible damage to your electric scooter.
- This e-scooter incorporates an electric hub motor located in the rear wheel.
- The hub motor is activated when the scooter is switched on and the throttle lever is pressed.
- The hub motor drive disengages as soon as one or both brake levers is/are pulled.
- This e-scooter is electronically limited to a maximum speed of 25km/h.
- Do not ride the e-scooter in rain, snow or icy conditions.
- Do not use the scooter when under the influence of medication or alcohol.
- Wear a helmet at all times when riding your e-scooter.

- Wear appropriate footwear when using this e-scooter.
- Your Busbi Hornet has a waterproof rating of IPX4, this means your Busbi Hornet is protected against splashes of water.
- This e-scooter must be properly maintained according to these instructions.
- Carry out periodic checks as described in this manual to ensure your e-scooter is in safe working order; read this manual carefully and ensure that you have understood all the product information before using it.
- **The e-scooter is delivered with cruise control enabled.**



CAUTION

You are advised to engage a professional tradesman to perform maintenance on your e-scooter every six months, to ensure it is in good working order and safe to use.

It is the owner's responsibility to ensure that all components are in safe working order before use.

Choose a safe place, away from traffic, to familiarise yourself with your new electric scooter. The hub motor may start in a sudden forceful manner, check that your handlebars are straight and that the path is clear.

Take time to familiarise yourself with riding and controlling your e-scooter to avoid a serious accident during the first few weeks.

Ensure you are in good health before riding your e-scooter.

In case of poor weather conditions, proceed with care and adjust your speed and reactions accordingly.

The user must comply with the requirements of national regulations when using the electric scooter on public roads (for example, lighting and signalling).



WARNING

As with any mechanical component, a vehicle is subject to high stresses and wear.

The various materials and components may react differently to wear or fatigue.

If the expected service life for a component has been exceeded, it may break suddenly, therefore risk causing injuries to the user. Cracks, scratches and discoloration in the areas subject to high stresses indicate the component has exceeded its service life and should be replaced.

IMPORTANT!

For your safety: Before each and every use, carry out the inspection schedule described at **Annex A, Table 1**, found at the end of this instruction manual.

2. Getting started.

Attention: Please fully charge your Busbi Hornet before first use.

Your Busbi Hornet e-scooter is a two wheeled electric scooter, powered by a Lithium-ion battery located inside the frame of the foot deck, and a hub motor incorporated in the rear wheel.

Your Busbi Hornet does not require connection with any external devices such as mobile phones in order to operate.

Attention: Your Busbi Hornet is delivered with cruise control enabled.

Please familiarise yourself with this function before riding.

2.1. Package Contents.

Please check the contents as listed below and retain your packaging in case the need to return your purchase.

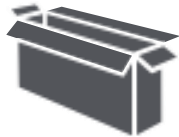

User Manual



Battery
Charger

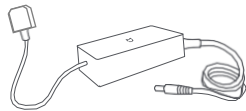

Extension Nozzle



Screws

4 x



Allen Key

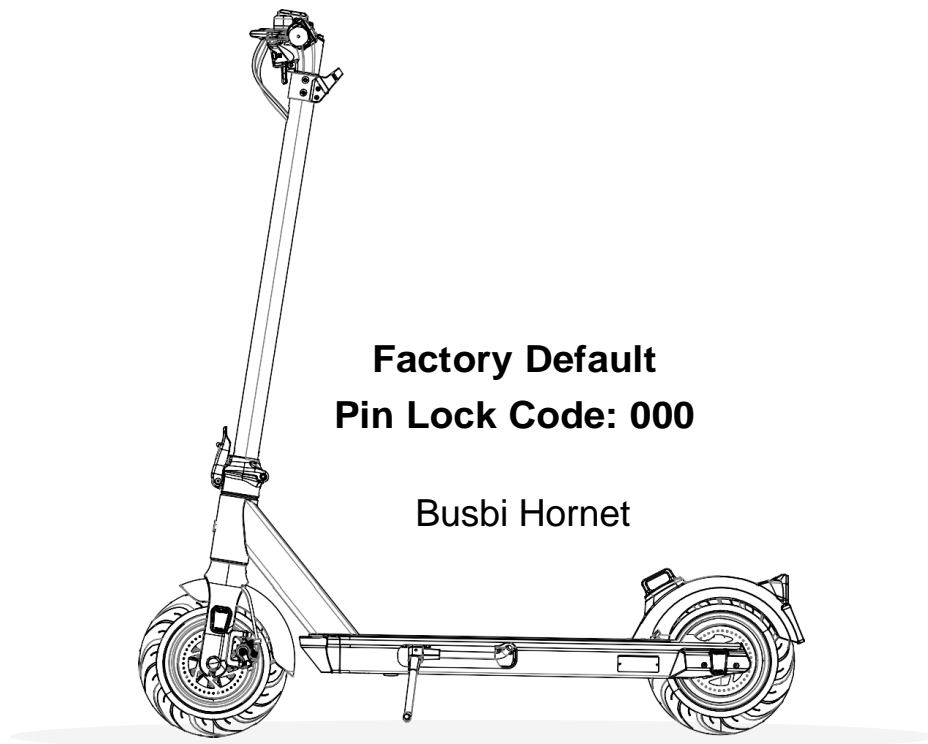

**Factory Default
Pin Lock Code: 000**

Busbi Hornet

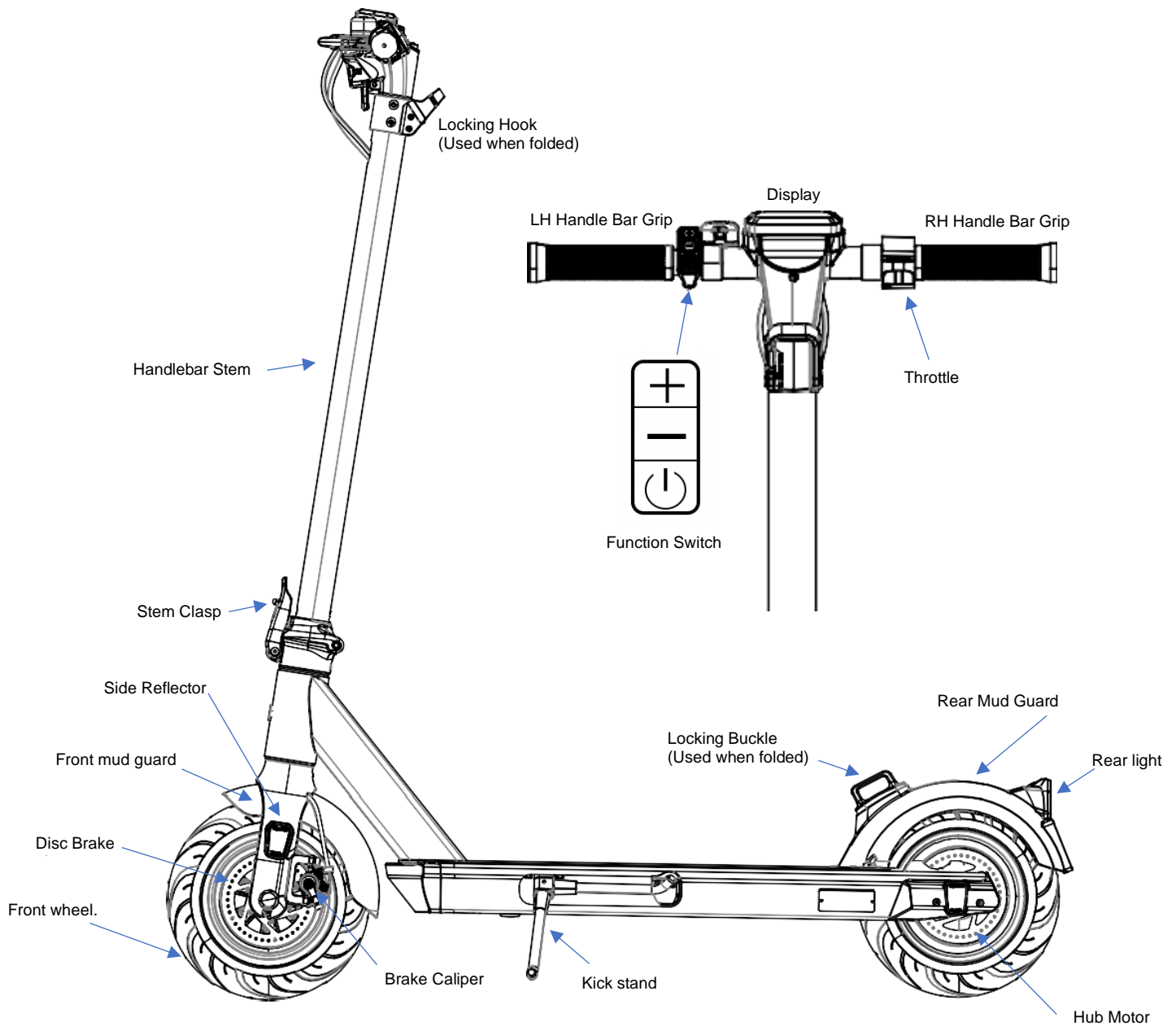
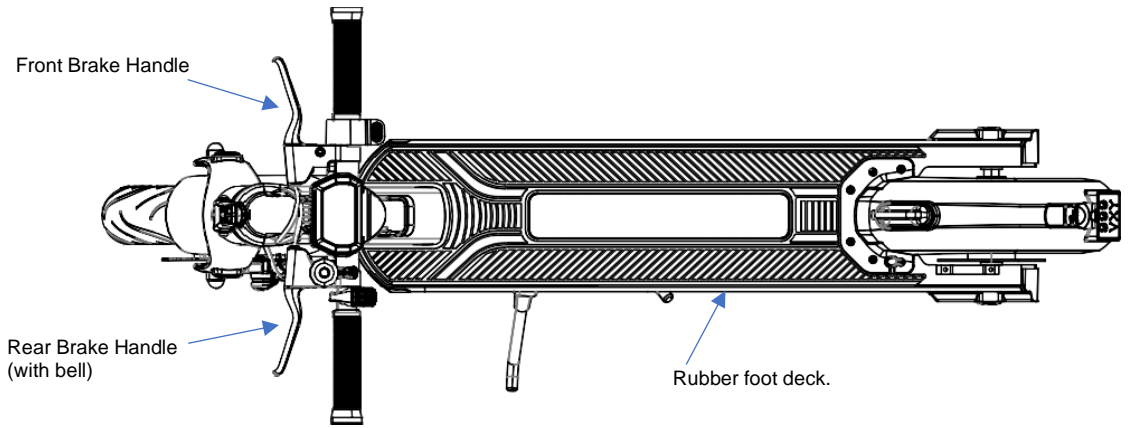

3. Preparing for first use:



3.1 Assembly.

Open the box and carefully take out all the parts, taking care to support the handlebars as you lift the scooter from the packaging.

Please retain the packaging, this will allow return of the product in the event of any problems.

Place the e-scooter on the floor.

Lift the handlebar stem while holding and supporting the handlebars.

Lift and close the Stem Clasp, ensuring it is securely locked.

Carefully insert the handlebars into the stem using the positioning guides to ensure correct alignment.

Attention: Take care not to pinch or damage electrical cabling.

Align the holes of the locking hook with the holes in the stem and handlebars.

Tighten the two screws on each side using the Allen Key provided. **Attention: Take care not to cross thread the screws.**

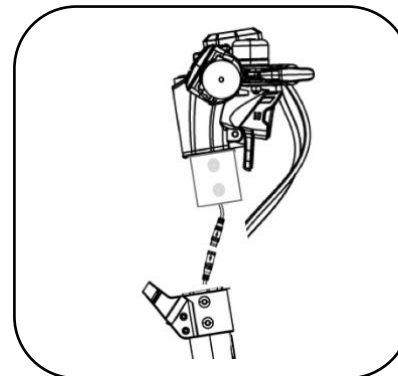
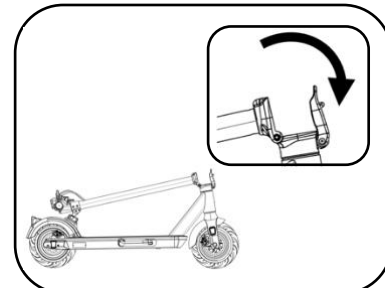

3.2 Brake Cables - Fitment

- Depress the brake lever and insert the head of the brake cable into the brake lever bracket.
- Thread the cable through the slot in the brake lever until the sheath fits into the port on the brake lever. **Attention: You must pull on the sheath to perform this operation.**
- Check the brake operation by pulling the brake lever and confirm brake calliper movement accompanied by inability to move the scooter through pushing.
- Repeat these steps for second brake lever. Verify the right lever operates the front brake calliper, and the left lever operates the rear brake calliper.

3.3 Folding and Unfolding the Busbi Hornet.

Unfold the handlebar stem:

- Press the side of the locking hook to open and release it from its locking buckle.
- Pull the hook out of the locking buckle.
- Lift the Handlebar Stem into a vertical position.
- Lift the Stem Clasp until the Handlebar Stem safety hook automatically locks over, ensuring it is securely locked.
- Lock over the Stem Clasp, ensuring the catch is securely locked.

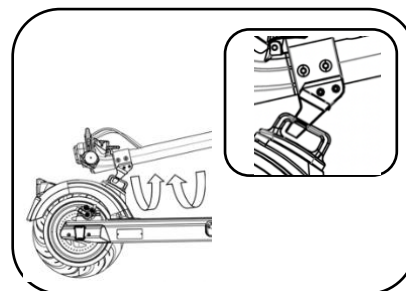

Lower the handle bar stem:

- Release and open the Stem Clasp by lifting the release catch and pulling the Stem Clasp away from the Handlebar Stem.
- Lower the Handlebar Stem until it sits parallel to the foot deck.
- Press the side of the locking hook to engage it in the locking buckle.

3.4 Charging. (See further guidance at page: 15)

Before first use, please fully charge your e-scooter.
Before charging ensure the charging port is dry and free from debris.

3.4.1 Connect the Charger

Use the included charger and connect it to the charging port. Now connect the 3 pin plug to the mains outlet. Observe the charging light on the charger.

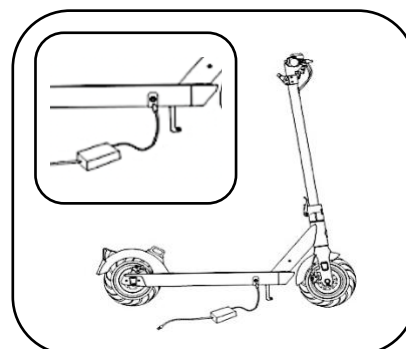

3.4.2 Charging Complete.

When fully charged, a **green light** on the charger indicates charging is complete. Disconnect the power supply from the charging port and ensure the charging port cover is closed securely.



WARNING

Failure to observe safe charging conditions.
Risk of fire, explosion and Injury.

- Charge in a well-ventilated space.
- Do not attempt to charge - if the charging port or power adaptor is wet.
- Only use charger specified by the manufacturer.
Manufacturer: Shenzhen Fuyuan Power Co., Ltd., Model: FY4202000
- Ambient temperature must be 0-40 C during charging.
- The battery will not charge outside of these temperature limits.
- Risk of Fire: Do not attempt to disassemble the charger.
- No user serviceable parts.



WARNING

Cruise Control is factory enabled on this e-scooter

Cruise control is engaged when in motion and the rider holds the throttle for 8 seconds at a constant speed. When activated cruise control is activated, an audible beep will sound. The rider may release the throttle and the e-scooter will maintain the constant speed attained when the beep sounded.

Cruise control is disengaged by pulling either brake lever.

Disabling Cruise Control.

To disable the cruise control function, simultaneously press and hold the: **+** and **-** buttons.



WARNING

Altered balance and handling characteristics due to additional weight.
Risk of serious injury.

Do not hang bags or items on the locking hook.

4. Riding your Busbi Hornet.

Step 1:

Before each use of the e-scooter carry out the **Pre-Use Inspection Schedule** that can be found in Table 1, Annex A at the end of this manual.

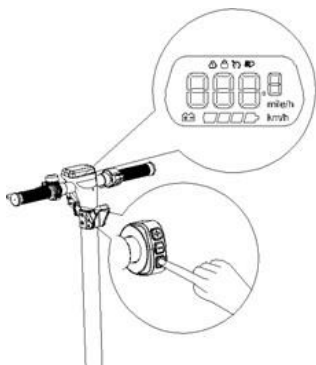

Step 2:

Unfold the scooter in accordance with the instructions provided in section 3.

Press the "On/Off" button.

Enter the electronic lock code as described in section 4.2.2
Your e-scooter is delivered with the default lock code '000'.

Step 3:

Once the scooter is switched on, check the stand is folded away, place one foot on the foot deck and then begin pushing forward on the ground with the other foot, gaining momentum without using the throttle.

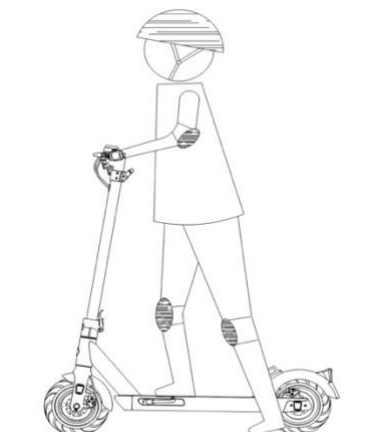

Step 4:

You must reach a speed of 3 km/h before the throttle will engage the motor. Once the threshold of 3km/h is reached, gently press the throttle and bring your other foot up onto the foot deck assuming a stable riding position.



Step 5:

To brake, release the throttle lever and pull the brake levers gently applying the rear brake first followed by the front brake, as described in section 4.1.

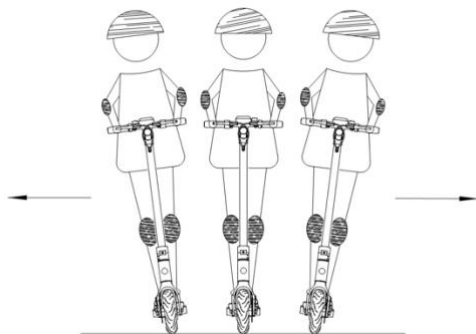

IMPORTANT:

- To avert any danger, sharp turns should always be avoided when traveling at high speed.
- Keep your body balanced when turning to avoid falling over due to high speeds or a shifting centre of gravity.

Step 6:

Once you have finished riding your Busbi Hornet, press and hold the On/Off button for 3 seconds to turn the scooter off.

4.1. Braking

- To slow down, simply release the throttle.
- To brake, do not pull the brake levers too hard or abruptly.
- The left brake lever activates the rear brake, the right lever activates the front brake.
- Begin by applying the rear brake followed by adding front braking.
- It is recommended to distribute your braking force 60/40 Rear/Front.
- Gradually apply increasing pressure to the brake lever.



WARNING

Braking efficiency reduced due to wet or slippery conditions.
Risk of serious injury.

Allow extra stopping distance in wet or slippery conditions.



CAUTION

- Do not tighten your brake cable more than necessary at the brake calliper.
- Avoid locking the wheels through excessive brake pressure, this may cause a loss of control and balance.
- Never touch the brake disc with your fingers after using the brake system, as this will be very hot and may cause burns.
- Before each use, ensure the front and rear brakes are in good working order.
- Damaged, frayed or rusty cables must be replaced immediately.
- Apply a suitable cable lubricant to brake cables every 3 months, to ensure freedom of movement.
- Take care to ensure no oil or contaminants come into contact with brake disks and brake pads.

4.2 Display Screen.

The display screen, located on the handlebars, displays the status of the scooter, providing the rider with the following information:

1. Battery charge level
2. Fault,
3. Pin lock status.
4. Cruise control status.
5. Lights
6. Speed

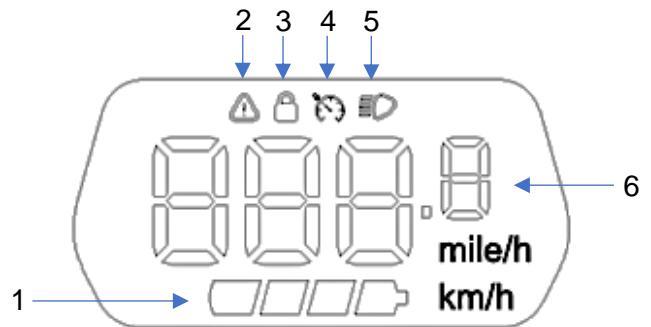

4.2.1 Fault Codes

Fault codes will assist in basic fault diagnosis. If a fault occurs a fault code will be generated. In this event, simultaneously press and hold the “On/Off” and “ - ” buttons for one second, one of the following fault codes will appear on the screen:

Fault Code	Fault
2	Throttle
4	Motor
5	Brakes



NOTE

Theft or use by unauthorised person.
Risk of loss of property.

**The Pin Lock does not prevent theft of the e-scooter.
Owners are advised to buy additional security device such as a bike lock.**

4.2.2. Unlocking the Busbi Hornet

(Pin Code - factory default: 000)

- Press the “On/Off” button for 3 seconds to switch on the scooter.
- Enter the code using the buttons on the control panel.
- The cursor will move to the first digit of the code, increase or decrease its value using the: **+** and **-** buttons.
- When the correct digit is displayed, briefly press the “On/Off” button to confirm the digit to be entered and move to the next digit.
- **When the correct pin code is displayed; briefly press the “On/Off” button twice to confirm the code entry.** The e-scooter will now be unlocked and ready to ride.

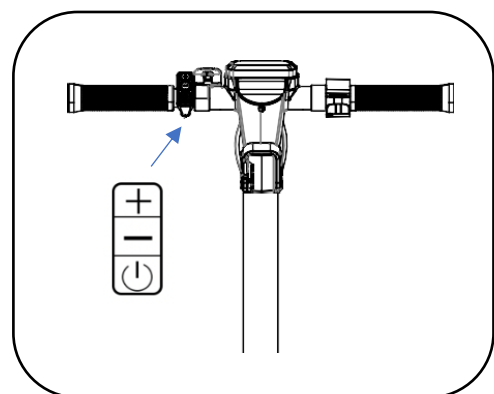

4.2.3 Pin Lock Function - Activating/Deactivating.

Press the “On/Off” button for 3 seconds to switch on the scooter.
Simultaneously press and hold the “On/Off” and “+” buttons for 5 seconds to activate/deactivate the code lock feature.

4.2.4. Changing the Pin Lock Code

- Press the “On/Off” button for 3 seconds to switch on the scooter.
- Simultaneously press and hold the “On/Off” and “-” buttons for 10 seconds to reset the lock code.
- The cursor will move to the first digit of the code - increase or decrease its value using the “+” and “-” buttons. Briefly press the “On/Off” button to confirm and move to the next digit.
- Briefly press the “On/Off” button twice to confirm the new code.

4.2.5. Lights - Operation:

Press and hold the “+” button for 2 seconds to turn on/off the headlight and taillight.

4.2.6. Speed modes:

Once moving, press the “+” or “-” button to switch speed modes.

- **Speed mode 1:** **10 km/h [6.2 mile/h] max speed**
- **Speed mode 2:** **15 km/h [9.3 mile/h] max speed**
- **Speed mode 3:** **25 km/h [15.5 mile/h] max speed**

Pedestrian mode:

Press and hold the “-” button for 3 seconds to enable the pedestrian mode (speed limited to 3 km/h). On the display, the number “3” blinks and the taillight flashes every 3 seconds.

Do not press the throttle lever at the same time as the pedestrian mode to prevent the electric scooter from starting up using the selected speed mode.

The pedestrian mode is used when the user must walk beside the scooter. The pedestrian mode reduces the effort required by ensuring a speed of 3 km/h.

5. Battery Charging

5.1. Battery Care and Safety.

- Do not store or charge the battery at temperatures outside of the stated limits (see specifications).
- Do not puncture the battery.
- Refer to your local laws and regulations regarding battery recycling/disposal.
- A well-maintained battery can perform well even after many miles of riding.
- Charge the battery after each ride to avoid draining the battery completely.
- When used at room temperature (20 °C) the battery range and performance is best.



WARNING

- Do not attempt to disassemble the battery.
- Risk of fire. No user serviceable parts.
- Do not ride when the ambient temperature is outside of the operation temperature (see specifications), because low/high temperature will limit the maximum power/torque. Doing so could cause personal injury or property damage due to slips or falls.

5.2. Using the Battery Charger.

Before charging the battery, note the following:

- Follow the instructions on the battery charger label.
- The charger is for indoor use only.
- Always protect the charger from rain and moisture.
- Do not use this charger near explosive gases or corrosive substances.
- Do not shake or hit the charger or allow it to fall.
- The operating temperature range of this charger is between 0 and 40°C.
- Do not attempt to disassemble the charger.
- In the event of a fault, immediately stop using and have the unit repaired by a qualified person.
- Only use the charger supplied with your electric scooter to avoid damage.
- When charging, the battery and charger should be at least 10 cm away from the wall and in a dry, well-ventilated place.
- Do not place anything in the direct vicinity of the charger during use.
- Avoid prolonged contact with the charger while charging as the unit will become hot to touch during normal operation.
- Do not place the charger in an unstable position.
- Do not cover the charger to avoid overheating while charging.
- Do not immerse the product
- Avoid any contact with water while recharging the battery.
- Do not use the charger with a damaged power cord or plugs.
- Ensure the charger plug is inserted fully into the mains outlet.
- Do not short-circuit the charger pins using a metal object.
- Disconnect the charger from the mains power source before connecting and disconnecting from the Busbi Hornet e-scooter.
- The external flexible cable of this product cannot be replaced; If the cord is damaged, the product should be discarded.

5.3. Charging Procedure.

- Open the silicone cap on the front right side of the foot deck, covering the charging port.
- Check the charging port is dry
- Insert the charger plug into the battery charging port.
- Plug the charger's power cord into the mains port.
- When charging, the LED on the charger will turn red to indicate proper operation.
- When LED changes to green, this indicates the battery is fully charged.
- Unplug the mains plug and then disconnect the cable from the charging port.
- Close the battery port cap.

CAUTION:

Charging for too long may shorten battery life:

- Do not leave your Busbi Hornet connected to the charger overnight.
- Do not charge the battery if the charging plug or socket are wet.
- Always fully charge your Busbi Hornet battery before first use and each time you subsequently charge it. This will maximise the service life of your battery.

For typical charging times: see "Battery Specifications".

5.4. Battery

This electric scooter is equipped with a high-quality Lithium-ion battery.

Lithium-ion batteries do not suffer from memory effect and have a wide temperature tolerance range from -10 to 40°C.

The battery is contained in a compartment under the e-scooter's foot deck.

To maximise battery life and to protect the battery from damage, please follow the use and care instructions below.

5.5. Battery Life

After charging your battery, it is advisable to allow 20 to 30 minutes before riding.

The operating life of your battery depends on several factors of use:

- Rider's Speed and acceleration behaviour
- The weight of the rider.
- Gradient of riding route.
- Tyre inflation.
- Wind conditions.
- Starting and stopping frequency.
- Outdoor temperature.

5.6. General Precautions.

As memory effect is not a concern with lithium-ion batteries, it is recommended to recharge the batteries on a regular basis, or after each use.

To maximise the service life of your battery, it is recommended:

- Avoid very hot and very cold places (ideal charging temperature 20°C)
- Allow the battery to cool for 30 minutes after riding your Busbi hornet.
- If your Busbi Hornet stops working due to overheating, place it in a cool, dry place and wait for the battery and hub motor to cool before using it again.

- Use only the specific charger supplied to charge the battery.
- Do not use any power supply or electrical device other than the one supplied with the device.
- Only charge the battery in a well-ventilated area.
- Do not expose the battery to heat or charge the e-scooter in direct sunlight.
- Do not disassemble or modify the battery case built into the footboard compartment of the scooter.
- Do not connect the (+) and (-) connections of the battery plug with a metal object.
- Do not expose the battery to liquids.
- Do not use a damaged battery.
- Do not continue to charge the battery if it is not fully charged after the theoretical charging time, see “Battery Specifications” below.
- Do not use the battery if it emits an unusual smell or becomes unusually hot.
- If the e-scooter is not used frequently over a period of time, it should be fully charged every 60 days.
- The scooter should be stored in a dry, protected place
- at a temperature between 5 and 35°C.
- Do not leave the battery charging for an extended period without attention.
- If the battery leaks, be careful not to let the liquid come into contact with the skin or eyes. If this happens, wash with plenty of water and seek medical attention.
- For battery repairs or replacement, contact a qualified technician.

5.7. Battery service life

Battery service life is dependent on usage profile.

Do not expose the battery to temperatures lower than -10°C or higher than 40°C. Doing so may affect its operation and life.

Batteries can suffer from ageing of their performance after numerous charges, this will be determined by usage habits.

5.8. Using the battery

To ensure maximum battery life and to protect the battery from damage, please follow the use and care instructions below:

- When the battery charge state falls to 25%, the battery should be recharged.
- When the battery icon on the display appears empty and flashes, it means that the voltage is low and the Busbi Hornet scooter will not have enough power to operate normally. In these circumstances switch off the Busbi Hornet and recharge the battery.



NOTE

Do not use the Busbi Hornet when the battery is low or the system requires a safe shutdown. Battery service life will be shortened if you continue to use the Busbi Hornet while the battery voltage is low.

6. General Maintenance:

6.1. Stem Locking Mechanism.

When the stem is correctly locked in the upright position, there should be no free play between the stem and folding mechanism.

The folding system must be checked regularly and at a maximum interval of **every three months**, to ascertain if any free play is noticeable in the stem.

Should free play be experienced when performing the above procedure or during riding, please follow the steps below to adjust the stopper.

Using a 5 mm Allen key, loosen screw [A] anticlockwise. Ensure to only loosen the screw, **do not remove the screw completely**.

- Using a 2.5 mm Allen key, tighten screw [B] clockwise.
- Using a 5 mm Allen key, tighten screw [A] clockwise.
- Check again that the stem can be unfolded and locked firmly and that there is no play.

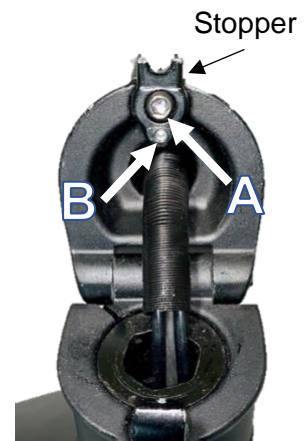

It is recommended to replace the stopper after 2 years. Contact your nearest dealer.

6.2. Brake Adjustment and Maintenance:

Wear and tear of the braking system is normal after frequent use of the Busbi Hornet. Some adjustment of the braking system will be required to maintain effective braking. The following procedures should be followed:

6.3. Adjusting the Mechanical Disc Brakes

The brake pads exert pressure on a disc attached to the wheel hub.

The pressure intensity is controlled by a brake lever via a cable.

If the brake is too tight or too loose, the brake cable must be adjusted to align the calliper with the brake disc.

To align the mechanical disc brake calliper, loosen the fastening screws of the brake calliper bracket. Gently pull the corresponding brake lever; the brake calliper will be drawn into the correct alignment. Hold the brake lever in this position while tightening the fastening screws of the calliper bracket.

Check the inner pad is 0.2 - 0.4 mm from the disc. If this is not enough, tighten the pad positioning screw until there is a 0.2 - 0.4 mm gap between the pad and the disc.

To adjust the outer pad, adjust the brake cable tension to achieve a gap of 0.2 - 0.4 mm at the calliper or brake lever level.

Never allow oil or any other lubricant to contaminate the disc or pads. If this happens, the pads and disc should be degreased or replaced.

Check the alignment of the brake pads by turning the wheel, observe and listen, ensuring the wheel turns freely.

6.4. Brake discs.

The Busbi Hornet is equipped with 12 cm (4.7 inch) diameter discs.

A nut and locknut system on the brake calliper allows you to adjust the cable tension and braking force, which will vary over time according to the wear of the brake pads.

6.5. Changing the brake pads.

Brake pads are standard, replace them when they no longer have a friction component.

Remove the wheel and remove the worn brake pads from the brake calliper.

Position the new pads in the calliper so that the braking surfaces are in contact.

Do not touch the braking surfaces. Insert the brake pads one after the other into the brake callipers. Now adjust and test the brakes.

7. Cleaning and Storage.

Use a soft, wet cloth to wipe the frame clean. Hard to remove dirt can be scrubbed with a toothbrush, then cleaned with a soft wet cloth.

Do not wash your Busbi Hornet with alcohol, petroleum, acetone, or other corrosive solvents. These substances may damage the appearance and internal structure of your Busbi Hornet. Do not wash your Busbi Hornet with a power washer or hose.



WARNING

Ensure your Busbi Hornet is powered OFF and the charging cable is unplugged before cleaning; otherwise you may damage the electronic components.

Storage Temperatures: -10 to +40°C.

IMPORTANT!

8. Further Guidance for safe use:

- Previous experience such as riding bicycles and skateboarding can be useful when learning to familiarise yourself with the Busbi Hornet e-scooter.
- For your safety before each and every use, please perform the **Inspection Schedule** found in **Table 1 at Annex A** of this instruction manual.
- For your personal safety and protection, wear adequate protection when riding the Busbi Hornet: appropriate footwear, helmet, gloves, knee pads, elbow pads etc.
- Do not modify your Busbi Hornet, this will invalidate any warranty and may reduce performance, cause damage and potentially cause serious injury.
- Do not fit accessories or additional items to Busbi Hornet that are not approved by the manufacturer.
- When riding be aware of your surroundings and always look in the direction of travel.
- Do not ride on wet roads, rainy weather or icy conditions. This could result in loss of traction and cause personal injury and irreparable damage to your e-scooter.
- Ride responsibly, adjusting your speed to match conditions and your ability.
- Operating the scooter under the influence of alcohol and/or drugs is prohibited and would likely result in serious injury.
- Always keep your hands on the handlebars when using the Busbi Hornet.
- You are accountable for your actions and should ride responsibly, so as not to cause damage and harm to persons or property.
- Avoid driving on unpaved roads or in areas with obstacles.
- Always keep both feet on the foot deck when riding.
- Keep in mind at all times that you can seriously injure yourself by losing control, colliding or falling off an e-scooter.
- Remember that you can injure yourself by losing control, colliding or falling off the Busbi Hornet.
- Do not use the Busbi Hornet in an unsafe environment where flammable products, vapours, liquids, dust or fibres may be present and cause a fire or explosion.
- It is prohibited to mount a seat on the electric scooter for use in a seated position. Your Busbi Hornet is designated a Class 2 PLEV.

8.1. Weight limits

- Maximum 100kg
- Minimum 20kg
- Observing the max and min weight limits the user's safety will avoid damaging the Busbi Hornet due to overloading.
- The combined weight of the user and belongings, must not exceed the maximum weight of 100kg.
- Exceeding the maximum weight or not meeting the minimum load weight of 20kg may cause the user to fall or be injured and may damage the Busbi Hornet.
- Failure to comply with the recommendations may result in the Busbi Hornet losing its ability to safely decelerate or stop while going downhill.
- It is forbidden for more than one person to ride the scooter.
- The Busbi Hornet is designed to be ridden by one person only. (Class 2 PLEV).

8.2. Maximum travel distance

- The maximum travel distance varies depending on several factors, such as:
- Terrain: Smooth, flat terrain increases the travel distance.
- Upward gradient reduces the distance.
- Avoid driving on steep slopes.
- User weight: The user weight affects the distance travelled.
- Ambient temperature: Storing and using the Busbi Hornet at the recommended temperature may increase the travel distance; using the Busbi Hornet outside of this temperature range reduces the travel distance.
- Speed and driving habits: Consistent, low operating speed increases the driving distance; conversely, frequent starting, stopping, accelerating and decelerating reduces the driving distance.
- Do not start and stop suddenly.
- Do not use the Busbi Hornet on slopes that are too steep a gradient.
- Accelerating on too steep a slope can cause the hub motor and battery to overheat.



WARNING! Protective equipment should be worn.

To avoid serious injury, always wear protective equipment: shoes, helmet, gloves, knee pads, elbow pads and wrist protectors.

9. Safety Features.

Lighting.

The LED lighting fitted to your Busbi e-scooter is powered by the scooter battery and consists of two lighting and reflector assemblies; a white headlight and red rear light assembly performing as a tail and brake light.

Four orange reflectors positioned left and right of the front and rear wheels, further enhance the visibility of the e-scooter.

The lighting system is a safety feature of your electric scooter.

Ensure that your lighting system is working properly before riding your e-scooter.

Bell.

A bell is installed on the handlebars.

The bell is a safety feature of your e-scooter allowing you to alert others of your presence, it must be installed on your handlebars.

Pin Lock.

By default, the scooter is equipped with an electronic pin code locking system, that prevents the e-scooter from being activated. When the Power On button is pressed, the control screen beeps and requires the unlock code to be entered. The default code is '000'. If you attempt to move the scooter without entering the code, the brakes will be activated, the front and rear lights will flash and a continuous beep will sound.

10. Busbi - Reducing Waste:

Here at Busbi we do everything we can to use little or no plastic in the packaging of our products. The packaging that your Busbi Hornet has been protected by, and delivered in, has been designed to be minimalistic and plastic free. In addition, there are no coloured inks or varnishes used on the cardboard packaging, allowing ease of recycling.

10.1. End of Product Life; Disposal and Recycling:



Information on Waste Disposal for Consumers of Electrical & Electronic Equipment

This mark on a product and/or accompanying documents indicates that when it is to be disposed, it must be treated as

Waste Electrical & Electronic Equipment (WEEE).

Any WEEE marked waste products must not be mixed with general household waste, but kept separate for the treatment, recovery and recycling of the materials used.

For proper treatment, recovery and recycling; please take all WEEE marked waste to your Local Authority Civic waste site, where it will be accepted free of charge.

If all consumers dispose of Waste Electrical & Electronic Equipment correctly, they will be helping to save valuable resources and preventing any potential negative effects upon human health and the environment, of any hazardous materials that the waste may contain.



Please recycle your spent batteries.

Batteries should not be disposed of in unsorted municipal waste, but separately collected to facilitate the correct treatment and recycling of the substances they contain. The recycling of batteries ensures the recovery of these valuable materials and prevents any potentially harmful effects upon both the environment and human health.

Please contribute to battery recycling by segregating all spent batteries and actively participating in their collection and recycling. Various battery collection schemes will be in operation in different areas of the country. However, battery collection bins will be available at retail stores that sell batteries as well as at schools, libraries and other public buildings.



Warning; Explosive material.



No open flame; Fire, open ignition source and smoking prohibited

Annex A

Before each and every use, carry out the inspection schedule described below:

Table 1 - Inspection Schedule	
All parts.	Check and confirm all screws and fasteners are tightened correctly.
Handlebar stem folding system and lock	<ul style="list-style-type: none"> • Ensure folding system is free from debris and obstructions. • Visually inspect handlebars and handlebar stem for cracks, deformation or discoloration. • Ensure handlebar stem locks securely in position, and is unable to inadvertently fold when riding.
Tyres	<ul style="list-style-type: none"> • Check and adjust tyre pressure to 50 PSI. • Visually inspect tyres for cracks or foreign bodies. • Check tyre tread is adequate to maintain grip when riding.
Frame	<ul style="list-style-type: none"> • Visually inspect frame for cracks, deformation or discolouration.
Wheels	<ul style="list-style-type: none"> • Visually inspect for correct positioning and alignment. • Visually inspect axles and nut and bolt joints.
Brakes	<ul style="list-style-type: none"> • Test brake functionality.
Thumb operated accelerator	<ul style="list-style-type: none"> • Check operation and freely returns to zero position after release.
Lighting	<ul style="list-style-type: none"> • Test (front / rear / brake) - lighting functionality.
Bell	<ul style="list-style-type: none"> • Test bell functionality.
Battery charging port	<ul style="list-style-type: none"> • Ensure cover securely closed.
Foot deck anti-slip matt	<ul style="list-style-type: none"> • Ensure secure.
Mud guards	<ul style="list-style-type: none"> • Ensure secure. • Ensure not obstructing wheel rotation.

Table 2 – Hornet Specifications	
Battery	36 V 7.8AH
Hub Motor	350W Average 500 W Maximum.
Range	Up to 28 km
Charging	Charge port
Splash Resistant	IP X4 (Can withstand splashing of water)
Lights	Front LED, automatic rear LED
Braking	Electronic and Hand Operated Disc x 2
Wheels	25.4 cm (10") Pneumatic with puncture resistant fluid
Top Speed	25 km/h (15.5 mph)
Climb	21.3% grade / 12 degrees
Weight Limit	100 kg
Storage Temperature	-10 to 40 °C
Operating Temperature	-10 to 40 °C

Table 3 - Charger Specifications	
Input Voltage	100-240AC, Output Voltage = 42VDC, Output Current: 2.0 Amps, Charger Manufacturer: Shenzhen Fuyuan Power Co., Ltd., Model: FY4202000 (Only Use Charger Provided)
Ambient Temperature while charging	0°C to 40°C

Table 4 – Hornet Dimensions	
Length x Width x Height	1140*460*1260 mm (Unfolded)
Weight	18.4 kg

Table 5 - Battery specifications

Type	Lithium-ion
Nominal Voltage	36V
Capacity	7.8 Ah
Number of cycles ($\geq 70\%$ capacity)	500 cycles
Maximum input	42V DC 2 Amp

EC DECLARATION OF CONFORMITY



THE EQUIPMENT WHICH ACCOMPANIES THIS DECLARATION IS IN CONFORMITY WITH THE FOLLOWING EU DIRECTIVES:

GENERAL PRODUCT SAFETY DIRECTIVE (2001/95/EC)
MACHINERY DIRECTIVE (MD) (2006/42/EC)
ELECTROMAGNETIC COMPATIBILITY (EMC) DIRECTIVE (2014/30/EU)
LOW VOLTAGE DIRECTIVE (LVD) (2014/35/EU)
BATTERY DIRECTIVE (2006/66/EC)
ROHS DIRECTIVE (2011/65/EU) WITH ITS AMENDMENTS COMMISSION DELEGATED DIRECTIVE (EU 2015/863)
REACH REGULATION (EC NO 1272/2008)

MANUFACTURER:

CMS Distribution Ltd.
CasOne, Freeway Dr, Castleford WF10 5EJ, United Kingdom

A copy of the Technical File for this equipment is available from the address above.

DESCRIPTION OF EQUIPMENT:

Model: **TT-EL-H101**
Marketed as: **Busbi Hornet.**
Designated as a Personal Light Electric Vehicle. (PLEV) Class 2.
An adult electric kick scooter, designed for recreational use.

EAN: **5051868 188497 451870**
Serial Number: **BH/101/XX/202X/XXXX**



THE FOLLOWING HARMONIZED STANDARDS HAVE BEEN USED:

EN 60335-1:2012+AC:2014+A11:2014+A13:2017+A1:2019+A14:2019+A2:2019
EN60335-2-29:2004+A11:2018, EN60335-1:2012+A2:2019; BS 62233:2008
EN ISO 12100:2010
EN 17128:2020
EN 61000-3-3:2013/A1:2019
EN 61000-3-2:2019
EN 55014-1: 2017/A11:2020
EN 55014-2: 2015

AUTHORISED SIGNATURES OF MANUFACTURER

Services Director
CMS Distribution Ltd.
12th March 2022

Rating Plate: found on the underside of the foot deck of your Busbi Hornet:

BH/101/XX/202X/XXXX	
<p>WARNING: Read the instruction manual and all warning labels on the product before using this product. Use only the charger supplied with this product.</p> <p>BUSBI</p> <p>Imported and Distributed by: CMS Distribution Ltd, CasOne, Freeway Drive, Castleford, South Yorks. WF10 5EJ.</p>	<p>Brand: Busbi</p> <p>Designation: PLEV (Class 2) EN 17128</p> <p>Model: HORNET (TT-EL-H101)</p> <p>DOM: March 2022</p> <p>Max Speed: 15.5mph (25km/h)</p> <p>Max load: 100kg</p> <p>Net Wt: 18.4kg</p> <p>IP Rating: IPX4</p> <p>Battery: Lithium-ion.</p> <p>Max Input: 42V DC 2 Amp 36VDC,</p> <p>Capacity: 7.8AH</p> <p>Motor:</p> <p>Rated Power: 350W</p> <p>Max Power: 500W</p>
 	Made China

For more guidance and support including videos to help you get started, please visit: busbistore.com/scooters/ or, simply open the camera app on your mobile phone, and point the camera at the QR code below:



BUSBI

HORNET

